

LIVEPICTURE GO



LIVEPICTURE GO

LivePicture GO offers a playful way of adding vertical greenery to your living, learning or working environment. The tank holds enough to water the plants for \pm 4 weeks. The capillary technology of the plant cassette ensures the plants always have the right amount of water. The LivePicture GO empty indicator shows when the water tank needs to be filled.

SIMPLE GREEN

The slots of the removable plant cassette are filled with plants based on your own preferences and tastes. LivePicture GO is highly versatile; it can be used indoor and outdoor, in a single or a modular set-up. Create a playful collage using multiple LivePicture GO units. Easily mount the living picture using the two screws and installation template provided.

NEW: LIVEPICTURE GO BAMBOO

New is LivePicture GO Bamboo, made of sustainable bamboo fibres. Bamboo is a natural and sustainable material and has a low environmental impact. Bamboo is biodegradable and 100% recyclable. This natural and sustainable material ensures that any LivePicture GO is unique. Not only the plants, but the frame also makes the LivePicture GO Bamboo green.



LIVEPICTURE GO MATERIALS

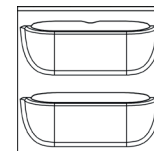

Cassettes: the front of the cassettes is made of air permeable Expanded Polypropylene (EPP). The backside is made of polypropylene (PP). The cassettes are fitted with capillary microfibre textile woven from 80% polyester and 20% polyamide. All materials can be reused and are fully recyclable.

Frame: The frame is made of Bamboo Bio blend or Acrylonitrile-styrene-acrylate (ASA) with a high weather resistance to UV radiation and is fully recyclable.



Back: The back plate of LivePicture GO is made of Acrylonitrile Butadiene Styrene (ABS) and is fully recyclable.

Parts: Smaller parts such as full level sensor, empty level sensor and filling opening are made from Polypropylene (PP) and are fully recyclable.

Tank: The tank in the LivePicture Go is made of Styrene-Acrylonitrile Resin (SAN) and is fully recyclable.



Plants: the plants used in the pre-cultivated cassettes in the LivePicture GO are grown at the Dartplant production site working according to 'On the way to PlanetProof' certification. This independent quality mark proves that the plants for the LivePicture GO have been produced more sustainably and are therefore a better choice for nature, climate and animals. The online Mobilane PlantGuide gives an overview of selected plant species that are recommended for planting the LivePicture GO.

UNIQUE FEATURES

Lightweight

No electricity or pump required

100% recyclable

Interchangeable plant cassettes

Water tank for ±4 weeks, equipped with full and empty indicators

Integrated watering system

Quick and easy installation

For indoors and outdoors



BENEFITS

Vertical greenery takes up little space

Improves the indoor climate and air quality

Helps increase concentration, productivity and general well-being

Improves the acoustics in a room

Sound-dampening effects

Lowers stress levels



SPECIFICATIONS LIVEPICTURE GO

Product	Dimensions (w x h x d)	Number of cassettes	Weight (empty)	Volume (in litres)
LivePicture GO	51.6 x 51.6 x 11.2 cm	1	2.7 kg	2 liter

AVAILABLE COLOURS

- 

White
- 

Bamboo
Natural
- 

Bamboo
Black

Other (RAL) colours and personalisation with own logo, design or photo are possible on request.

INSTALLATION & MAINTENANCE



LivePicture GO installation requires a spirit level, pencil and drill. All wall mounting materials are included. The LivePicture GO comes with a template and instructions and can be easily attached to a vertical surface with two screws. You can fill the slots of the removable plant cassette with plants according to your own preference and taste. Your choice of plants must be made based upon a few factors; location and light levels as to where the LivePicture GO will be installed. View the PlantGuide on our website for tips.

WATERING

Thanks to the low-maintenance system, the plants remain beautiful and vibrant for many years. The water tank is sufficient to provide the plants with water for approximately \pm 4 weeks. No electricity or a pump is needed, so the LivePicture GO can hang in any desired location. The water empty indicator - indicates when the water reservoir will need to be topped up. The capillary action of the plant cassette provides the plants with the right amount of water. The frame can be cleaned with a soft micro cloth. The use of aggressive cleaning agents is not recommended.

PRUNING

Pruning of the plants in the cassettes can be done throughout the year. Pruning dead or unhealthy material will encourage new growth. The planting becomes more compact, fuller and retains its fresh appearance when regularly pruned.

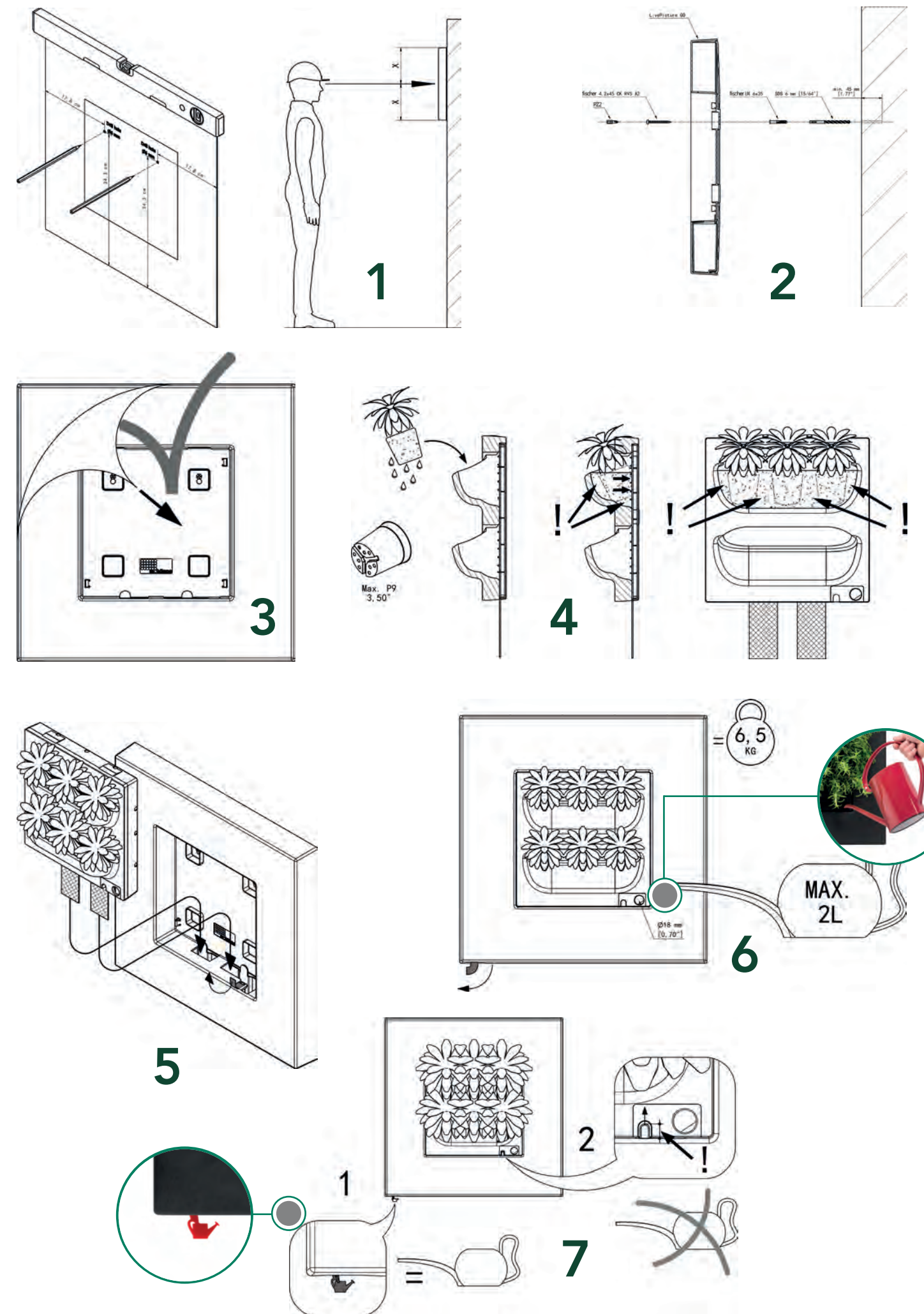

REFERENCES AND APPLICATIONS



RESIDENTIAL



RESIDENTIAL



OFFICES



RESIDENTIAL

